



Maple & Pine

Immersed in nature.

Nestled in the heart of Bundaleer Forest, Maple & Pine is a welcoming, down to earth wedding venue where beauty meets freedom. Here, the forest becomes part of your story, timeless, photogenic, and always evolving with the seasons.

Unlike wineries and estates, Maple & Pine offers true dry hire. That means no inflated packages, no rigid rules, just the space, the forest, and the freedom to shape your day exactly as you want it.

)) Your day, your way, in a forest venue like no other.



Your day, your way.

At Maple & Pine, there is no set formula. Want your favourite caterer? Your choice. Craft beers and homemade wine? Bring them along. Formal sit down or relaxed cocktail style? Both work beautifully here.

With three full days of exclusive access, you have the freedom to create your celebration at your own pace and in your own style, making every moment feel truly yours.

No pressure. No pretence. Just freedom in a forest.



No pressure. No pretence.
Just freedom in a forest.

Image: Jordan Ester Photography



Destination to the Southern Flinders.

Located three hours north of Adelaide and just ten minutes from Jamestown, Maple & Pine is a natural meeting point for families spread across South Australia. For locals, it is your forest venue, easy, practical, and close to home. For families coming together from Adelaide, Upper Spencer Gulf, Eyre Peninsula, and Flinders Ranges, it is the perfect central destination to turn a wedding into a weekend.

With local group accommodation and private stay options, onsite camping available at request, and itineraries that showcase the best of the Southern Flinders, you and your guests can make memories that go well beyond one day.



Function Spaces.



Function Room

Space: 108m² | Capacity: 110 seated or 160 standing | R/C Airconditioning
| Sound System (four speakers) | Samsung 100cm Smart TV
Special features: Bridal Suite/Green Room | Polished Timber Floors.

Deck

Space: 110m² | Capacity: 100 seated or 160 standing | Pull-down Blinds
| Electric Wall Heating | Large Fans | 115 amp / 10 amp / 3-phase Power
Supplies. Special features: Festoon Lighting on Deck

Lawns

Space: 1000m² Lawn (wrapping three sides of Maple & Pine)
Special features: Flat terrain at the front for alfresco events, or installation
of a marquee up to 16m x 14m.



Image: Bec Smart Photography



Floor Plan

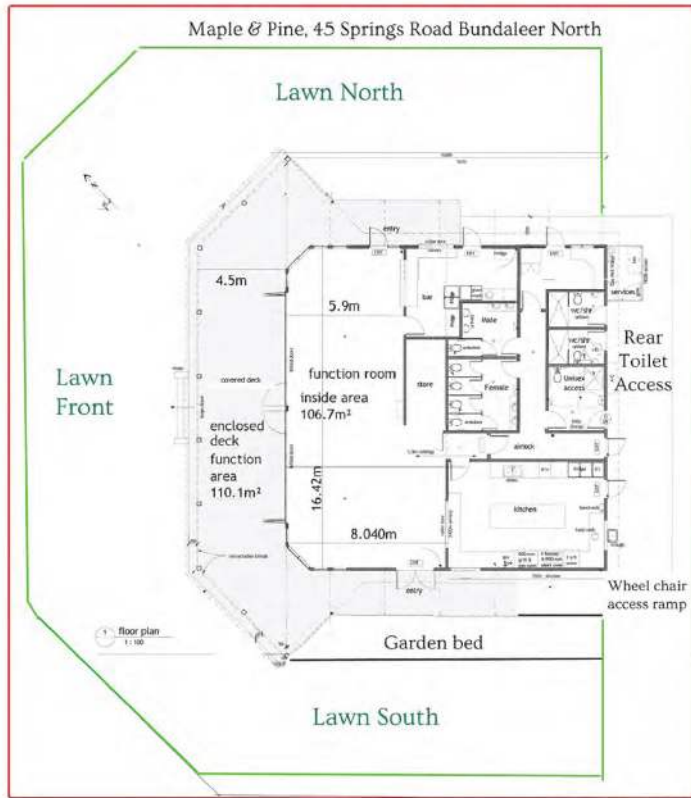

Lower Car Park

Wheel chair car parks x 3

Amenities & Facilities.



Heating & Cooling

Our function room has reverse cycle air conditioning, making it cosy in winter and cool in summer. Our deck wall heaters and ceiling fans provide year round comfort for alfresco events.

Sound

Professional sound system features speakers in the function room & on the deck ensuring that your guests can enjoy clear audio throughout the venue.

Lighting

Stunning interior lighting design in the function room with a range of options to choose from for your event. Fairy lights in the function room and festoon lights on the deck add ambiance to your event.

Power

Sufficient 0amp and 15amp power points to support musicians and food/coffee vans.

Wifi

Wedding clients have access to Maple & Pine wifi for the duration of the hire.

TV Screen

Project a slide show or a simple backdrop on our Samsung Frame TV.





Image: Bec Smart Photography

Bathrooms

- Disabled Access Bathroom
- 4 x Female Bathrooms
- 3 x Male Bathrooms
- 2 x Bathroom / Shower Rooms
- Baby Change Facility
- Cosy Baby-Feeding area on request

Kitchen

Our kitchen provides a large range of catering facilities to accommodate your special day.

- Large Stainless Steel Benches

- Commercial Appliances:

- 900mm six-burner gas cooktop
- 600mm gas griddle plate
- 600mm gas oven
- 900mm electric oven
- 600mm electronic ovens x 2
- Microwave
- Commercial Dishwasher

- Crockery & Cutlery

- 120 x side plates | entree plates | dessert/soup bowls | dinner plates | large knives | small knives | large forks | small forks | dessert spoons | soup spoons | teaspoons
- 60 x mugs | 30 x white cups & saucers

Bar

- Commercial Appliances:

- 2 x Large glass-fronted drinks fridge
- Glasswasher - fast & easy to use
- Freezer for ice

- Glassware

- 100 x champagne flutes | wine glasses | drinking glasses

- Cocktail glasses are available to hire

- Portable coolroom available to hire

Ceremony Locations.

Oak Tree

Shaded by towering oaks, elms, maples and poplars, this location is relatively flat and easy to access. It is a short walk (200 metres) which provides a perfect stroll for guests between the ceremony and reception.

Vehicle access is available for bridal cars and those with mobility restrictions.

Heritage Charm

The timeless charm of heritage stone buildings nearby lends an air of elegance and history to your photos, making your wedding day not just an event, but a timeless story preserved in stone and landscape.



Maple & Pine Lawns

Maple & Pine lawns offer the ultimate in convenience. Choose from the backdrop of spotted gums. Or if you prefer, our wide timber deck makes a perfect spot to take your vows.



Image: Bec Smart Photography



Image: Bec Smart Photography

Gum on the Maple Walk

A 500 metre from Maple & Pine, along the stunning Maple Walk, you will find a ceremony location tucked amongst the trees.

This area can also be reached by vehicle for those with mobility restrictions.

Pricing at a Glance.

September to May

Peak season weddings with full access to Maple & Pine and surrounds for three full days.

\$4500

June to August

Maple & Pine's stunning glass-wrapped function room, pull-down blinds on the timber deck and indoor / outdoor heating systems make winter weddings a dream.

\$4000

Wednesday Wedding

Mid-week weddings have become increasingly popular. Your hire commences on a Tuesday and concludes Thursday afternoon.

\$3500

Prices are subject to change.



Booking Process.

- 1 Enquiry & Book Venue Tour**
Email admin@mapleandpine.com.au
- 2 Confirm Availability**
7 day holds on up to three dates to secure your preferred suppliers.
- 3 Secure Your Date**
By providing signed contract and \$550 confirmation payment.
- 4 Second Walk-Through**
To plan the event layout.
- 5 Final Payment**
Due 60 days prior to your event.
- 6 14-30 Days Pre-event Walk Through**
Finalise setup details.
- 7 Event Day!**
Enjoy your day, your way.



A Few Rules.

You'll step into a clean and tidy space, and all we ask is that it's returned the same way.



Smoking Policy

Smoking & vaping is strictly prohibited at Maple & Pine, including inside the venue, on the deck, the lawn gardens and forest surrounds. Designated smoking areas can be found in the car park adjacent to the fire water tank.

Alcohol and Beverages

Alcohol must be served responsibly and only to guests of legal drinking age. Any unauthorised sale or distribution of alcohol is strictly prohibited. You may bring your own alcohol and serve yourself or ask us for a quote to serve you.

Decorations & Alterations

You're welcome to decorate the venue to suit your event theme, but please consult with our team for approval of major decorations or alterations. Any decorations must be non-destructive and removed at the end of the event.

Capacity Limits

The maximum occupancy for the venue must be strictly adhered to for safety reasons. This includes both indoor and outdoor areas.

Clean Up & Waste Disposal

The event area must be left in the same condition as it was found. All trash and debris must be properly disposed of in designated receptacles. Failure to clean up may result in additional cleaning fees.

Damages & Liability

The client assumes full responsibility for any damage caused to the venue's property or equipment during the event. A security deposit is required to cover potential damages and will be returned if no damage occurs.



Some FAQ



What is the capacity of your venue?

Our function room can accommodate 100 guests and our deck can accommodate an additional 80 seated guests.

150 seated guests or 250 standing guests.

What is included in the rental package?

Our rental package includes our entire venue, including full commercial kitchen bar and amenities, plus our sound system (function room and deck). Additional services like catering and decorations can be added as needed - just speak to our venue team.

Can I bring my own vendors?

Yes, you're welcome to bring your preferred vendors for catering, photography, and other services. We have an amazing range of Southern Flinders Ranges businesses to help bring your event to life.

What is the deposit amount, and is it refundable?

A Confirmation Payment of \$550 is required to secure the booking and is transferable but not refundable. We understand plans change and will work with you to help bring your event to life.

Can I tour the venue before making a decision?

Absolutely! We encourage all clients to schedule a tour with our team to see the venue in person and discuss your event needs.

Can I decorate the venue to fit my event theme?

Yes, you can decorate the venue to match your event theme. However, please consult with us regarding any major decorations or alterations to ensure they comply with safety and venue guidelines.



))

Start your story in
South Australia's only
immersive forest venue.



Ready to begin?

Every couple who chooses Maple & Pine brings the forest to life in their own way. Some keep it simple. Some go all out. All leave with a day that feels personal, beautiful, and true.

Enquire with us to start your story.



www.mapleandpine.com.au

admin@mapleandpine.com.au

0467 002 256

Bundaleer Forest
45 Springs Road, Bundaleer North
South Australia